

Holy Trinity, Ashe Overton, Hampshire RG25 3AQ

Dr Peter Wardle

<http://theparishchurch.co.uk>

23/11/2017

Version 1

Introduction

Location: Village Centre

Open: Closed Parking: On road

Month & Year Photographed: June 2017

Date Photographed 6/19/2017

Use: In Use

Type of Church: Parish Church

Listing Grade: II

Date: Victorian Century: C19, Precise Date: 1878

Architect: Scott GG Jnr

Materials: Flint with Ashlar Dressings

Roof Materials: Tile

Historic Features: .



These photographs may not be used for commercial purposes. They may not be used for statements of significance or academic research at Masters Level or above except with the prior permission of Dr Wardle.

Plan Form & Chronology

Plan form Nave & Chancel

Position of Porch South

Single or Multiphase: Multiple phase

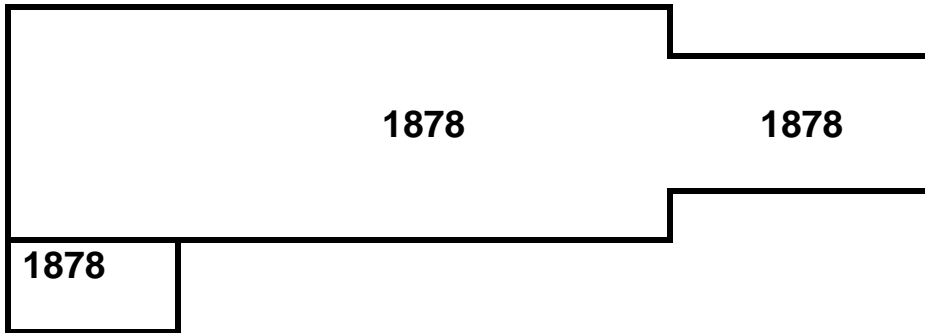

Exterior
General





Tower

Tower Type: Spirelet

Period: Victorian 1908 Contemporary with rest of building

Position: West Shape: Square

Parapet: None Roof: Spirelet

Number of Stages 1

Materials: Timber

